

InFlow Series

Modular, highly adaptable flow-through housings

Technical Data

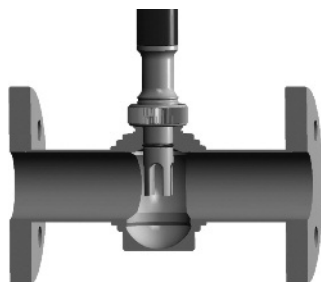

InFlow 76X



InFlow 751

Short description

InFlow® 76X flow-through housings from METTLER TOLEDO are designed to enable safe and reliable mounting of the InTrac® and InFit® Series sensor housings directly into the process or in a bypass (pipe). These rugged flow-through housings are specially suited to the requirements of the process industry and can be easily and safely installed, allowing reliable measurement procedures.

InFlow 751 flow-through housings serve for the direct fitting of METTLER TOLEDO electrodes and sensors for the measurement of pH, ORP, dissolved oxygen, conductivity and turbidity, particularly in the field of industrial wastewater treatment. The housings protect electrodes/sensors against mechanical damage.

These flow-through housings feature the following highlights:

- optimally designed for use with METTLER TOLEDO housings and sensors
- available in different materials
- wide pressure and temperature ranges
- 180° or 90° versions available
- highly adaptable process connection

Contents

InFlow 76X	2	InFlow 751	8
System structure InFlow 76X Series	2	System structure InFlow 751 Series	8
Complete measuring system and possible installation	2	Complete measuring system and possible installation	8
Dimensional drawings InFlow 76X Series	3	Dimensional drawings InFlow 751 Series	9
Technical specifications InFlow 76X	5	Technical specifications InFlow 751	10
Pressure/temperature diagram	6	Pressure/temperature diagram	10
Suitable InTrac and InFit housings	6	Product key InFlow 751	11
Product key InFlow 76X	7	Ordering information InFlow 751	11
Ordering information InFlow 762	7		

METTLER TOLEDO

System structure InFlow 76X Series

The InFlow 76X Series of modular flow-through housings work in conjunction with our InTrac and InFit housings, and available in stainless steel (1.4404/316L) or PVDF. For adaption of the InTrac or InFit housings, a DN50 flange or DN25 INGOLD socket are available.

The InFlow 76X can be directly integrated into a process or bypass pipe by using our available DIN or ANSI flange adaptors with dimensions DN25 (1") or DN50 (2"). Direct welding into a pipe is also possible. For optimal adaption to the process, we can supply both 180° and 90° versions.

The InFlow 76X Series is a highly flexible connection system for the optimal integration of a measuring loop.

Complete measuring system and possible installation

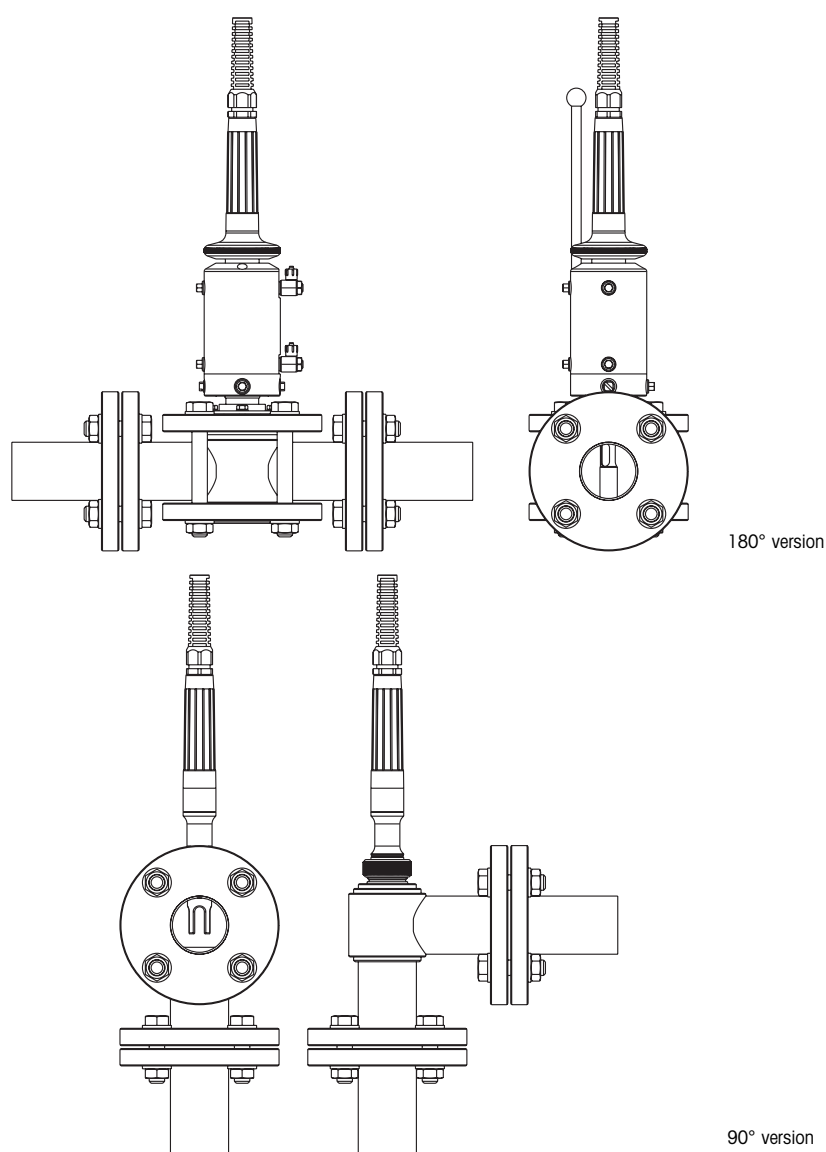

Examples of possible assembly of an InFlow flow-through housing on a pipe, either as a 180° or 90° version. There is the choice of combination with either an InTrac or an InFit housing.

Dimensional drawings InFlow 76X Series

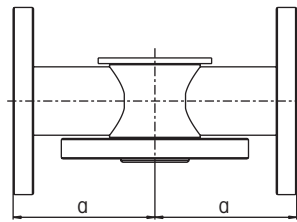

180° version

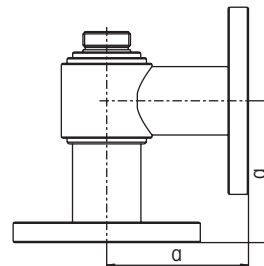

90° version

Flow-through housing with flange connection

	a
InFlow 761, 1.4404/316L	125 mm/4.92"
InFlow 762, PVDF	150 mm/5.91"

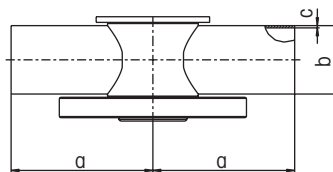

180° version

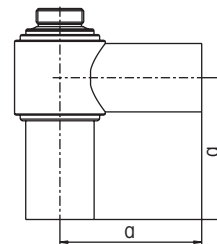

90° version

Flow-through housing with welded connection

	a	b	c
InFlow 761, 1.4404/316L			
DN25	125 mm/4.92"	33.7 mm/1.33"	2.0 mm/0.08"
DN50	125 mm/4.92"	60.3 mm/2.37"	2.0 mm/0.08"
InFlow 762, PVDF			
DN25	150 mm/5.91"	32 mm/1.26"	2.4 mm/0.09"
DN50	150 mm/5.91"	63 mm/2.48"	3.0 mm/0.12"

Dimensional drawings InFlow 76X Series (cont.)

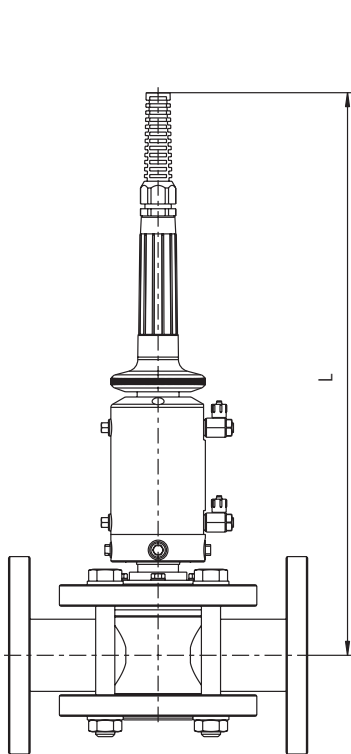

Measuring position

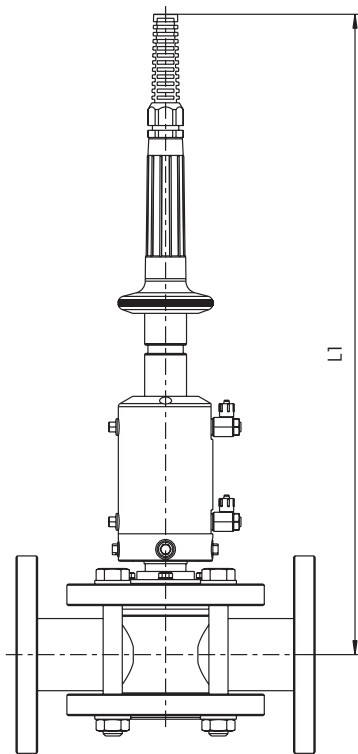

InFlow 76X with InTrac 777 e

Maintenance position

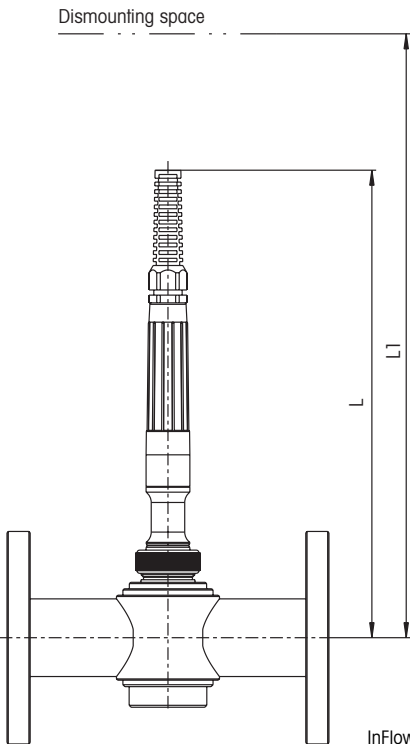

InFlow 76X with InFit 761 e

Flow-through housing in combination with InFit and InTrac housing			
	L		L1
InTrac 776 e	650 mm/25.59"		715 mm/28.15"
InTrac 777 e	470 mm/18.5"		535 mm/21.06"
InFit 764 e	510 mm/20.08"		640 mm/25.2"
InFit 761 e	363 mm/14.29"		493 mm/19.41"

Technical specifications InFlow 76X

Ambient conditions	
Temperature	–40 ... +100 °C (–40 ... +212 °F)
Max. admissible pressure [PS]/[TS] (linear relation)	PVDF: 6 bar/80 °C (87 psig/176 °F) 1 bar/140 °C (14.5 psig/284 °F)
	1.4404/316L: 16 bar/140 °C (232 psig/284 °F)
	Please refer to the pressure/temperature diagram on page 6!
Medium-wetted materials	
InFlow 761:	1.4404/316L
InFlow 762:	PVDF (version INGOLD DN25 with Viton O-ring)
Weight	InFlow 761: approx. 10 kg (22 lbs)
	InFlow 762: approx. 6 kg (13 lbs)
Pressure domain	
According to PED 97/23/EC, Article 1, Section 2.2: "Pressure" means pressure relative to atmospheric pressure, i.e. gauge pressure. As a consequence, vacuum is designated by a negative value.	
Certificates/approvals	
<ul style="list-style-type: none"> – Depending on housing model, following certificates/approvals are included: – CE Declaration of Conformity – Pressure Equipment directive, – Certificate of Conformity according to EN10204 2.1, material certificate according to 3.1B 	

Pressure/temperature diagram

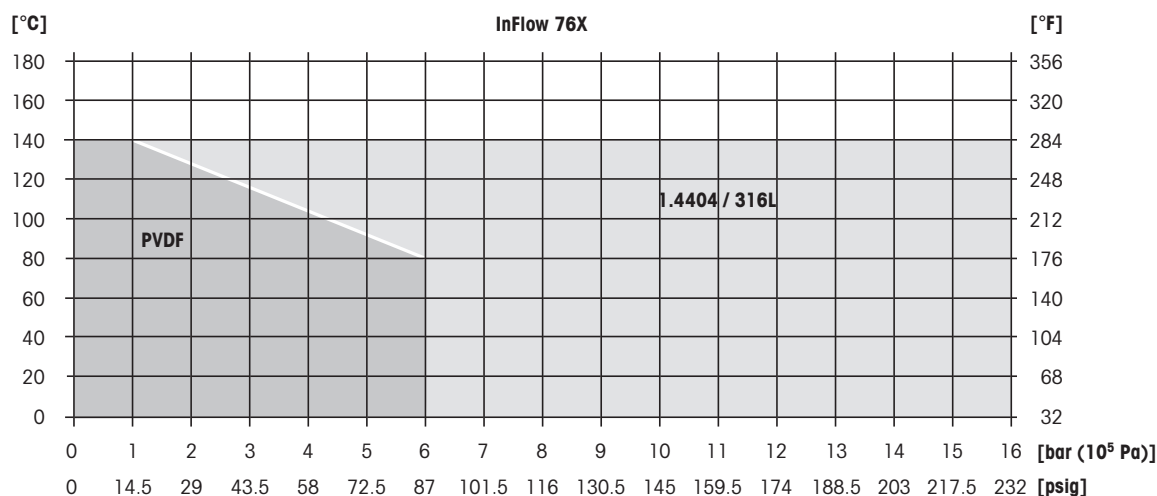

Suitable InTrac and InFit housings

InFlow	InTrac	InFit
InFlow 761, 1.4404/316L		
InFlow 761 INGOLD DN25	InTrac series housing with recommended insertion length 70–100mm; stainless steel, and DN25 Ingold housing adaptation.	InFit 76X/xS/70/4435/ D00/xxxx InFit 76X/xS/70/4435/ D11/xxxx InFit 76X/xS/70/4435/ D10/xxxx
InFlow 761 flange DN50	InTrac series housing with recommended insertion length 70–100mm; stainless steel, and DN50 flange housing adaptation.	on request
InFlow 762, PVDF		
InFlow 762 INGOLD DN25	InTrac series housing with recommended insertion length 70–100mm; PVDF, and DN25 Ingold housing adaptation.	InFit 76X/xS/70/PVDF/ D00/xxxx
InFlow 762 flange DN50	InTrac series housing with recommended insertion length 70–100mm; PVDF, and DN50 flange housing adaptation.	InFit 76X/xS/70/PVDF/ D04/xxxx

Please contact your local METTLER TOLEDO representative for more options

Material *									
1	/	4	4	0	4	1.4404/316L			
2	/	P	V	D	F	PVDF (polyvinylidenefluoride)			
Flow-through direction									
1	8	0	180°						
—	9	0	90°						
Process connection *									
D	2	5	DIN flange DN25 PN16						
D	5	0	DIN flange DN50 PN16						
A	0	1	ANSI flange A150-1"						
A	0	2	ANSI flange A150-2"						
W	2	5	Welding connection DN25 (1")						
W	5	0	Welding connection DN50 (2")						
Housing connection *									
D	0	0	INGOLD DN25						
D	0	4	DIN flange DN50						
Special									
—	Standard								
S	Special								

* others on request

The PVDF version with INGOLD DN25 socket is fitted with a medium-wetted O-ring made of Viton®. O-ring sets made of EPDM and Kalrez® are available as accessories.

- | | |
|----------------------------------------|------------------|
| Ordering information InFlow 76X | Order No. |
|----------------------------------------|------------------|

InFlow 762	
InFlow762/PVDF/180/D25/D00/-	59800816
InFlow762/PVDF/180/A02/D00/-	59800842
InFlow762/PVDF/180/W25/D00/-	59800843

Accessories for InFlow 762	
O-ring set for InFlow 762 with INGOLD DN25, EPDM	52 403 716
O-ring set for InFlow 762 with INGOLD DN25, Kalrez	52 403 717
O-ring set for InFlow 762 with INGOLD DN 25, Viton	52 403 715

System structure InFlow 751 Series

InFlow 751 flow-through housings serve for the direct fitting of METTLER TOLEDO electrodes and sensors for the measurement of pH, ORP, dissolved oxygen, conductivity and turbidity, particularly in the field of industrial wastewater treatment. The housings protect electrodes/sensors against mechanical damage.

The plug-in connection allows easy, uncomplicated change of electrode/sensor. All parts of the housing which come into contact with the process medium are made of PVC or PVDF. Process-wetted O-rings are made of Viton.

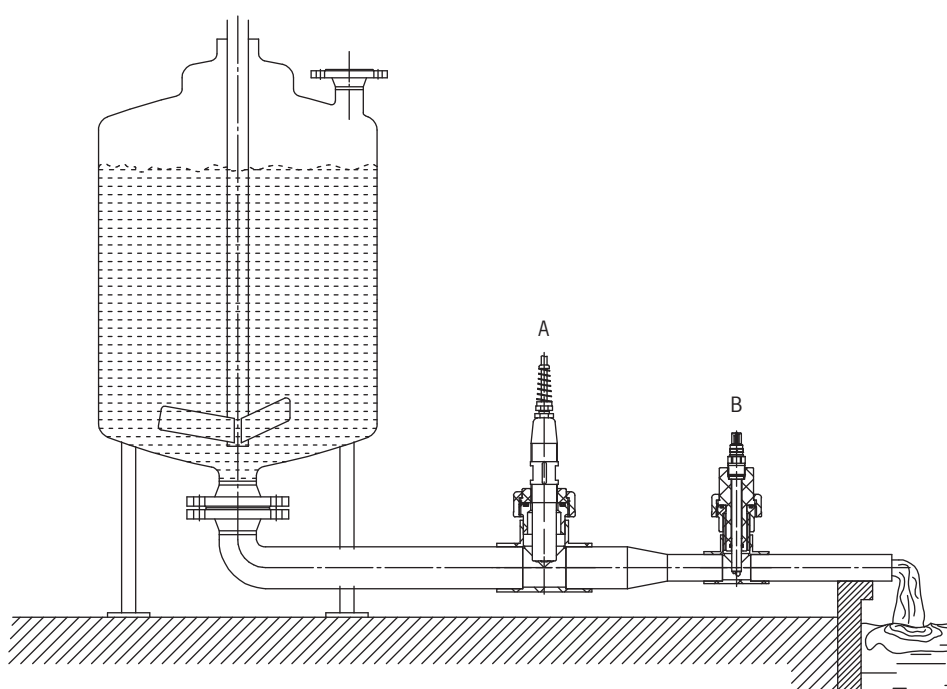
Complete measuring system and possible installation

Pipe installation in PVC or PVDF lines

A InFlow 751 with 1" NPT electrode

B InFlow 751 with 12 mm sensor/electrode

Dimensional drawings InFlow 751 Series

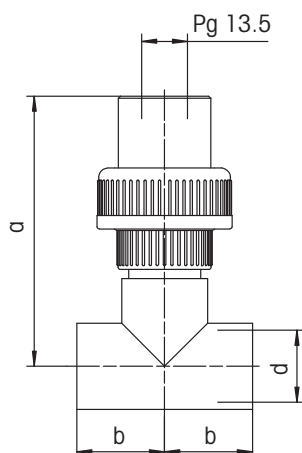

InFlow 751 – Pg 13.5

Pg 13.5	d	PVC		PVDF	
		a	b	a	b
DN25	32 (1.26")	120 (4.70")	39 (1.53")	120 (4.70")	38 (1.49")
DN40	50 (1.97")	113 (4.45")	57 (2.24")	113 (4.45")	51 (2.01")
DN50	63 (2.48")	107.5 (4.23")	71 (2.80")	106.5 (4.19")	

All dimensions in mm (inch)

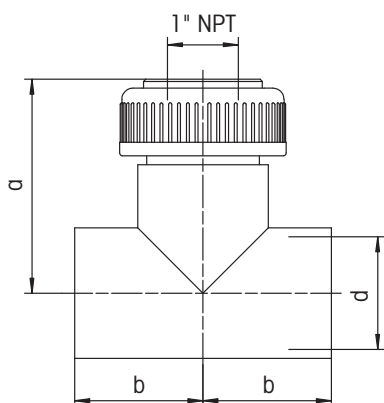

InFlow 751 – NPT 1"

NPT 1"	d	PVC		PVDF	
		a	b	a	b
DN40	50 (1.97")	93 (3.66")	57 (2.24")	88 (3.46")	51 (2.01")
DN50	63 (2.48")	108 (4.25")	71 (2.80")	102 (4.19")	62 (2.44")

All dimensions in mm (inch)

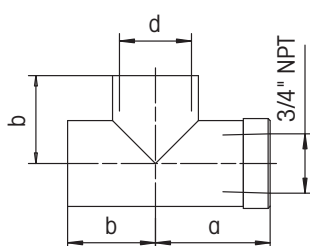

InFlow 751 – NPT 3/4"

NPT 3/4"	d	PVC		PVDF	
		a	b	a	b
DN25	32 (1.26")	51 (2.01")	39 (1.53")	51 (2.01")	38 (1.49")
DN40	50 (1.97")	63 (2.48")	57 (2.24")	63 (2.48")	51 (2.01")
DN50	63 (2.48")	77 (3.03")	71 (2.80")	77 (3.03")	62 (2.44")

All dimensions in mm (inch)

Technical specifications InFlow 751

Ambient conditions	
Temperature	0 ... 70 °C (32 ... 158 °F)
Max. admissible pressure [PS]/[TS] * (linear relation)	PVC: 4 bar/45 °C (58 psig/113 °F) 1 bar/60 °C (14.5 psig/140 °F) PVDF: 4 bar/75 °C (58 psig/167 °F) 1 bar/100 °C (14.5 psig/212 °F) Please refer to the pressure/temperature diagram below.
Wetted material	PVC, PVDF
Wetted seals	Viton-FDA
Adaption to process pipe	Ø 32 mm, 50 mm, 63 mm (DN25, DN40, DN50)
Pressure domain	According to PED 97/23/EC, Article 1, Section 2.2: "Pressure" means pressure relative to atmospheric pressure, i.e. gauge pressure. As a consequence, vacuum is designated by a negative value.

Pressure/temperature diagram

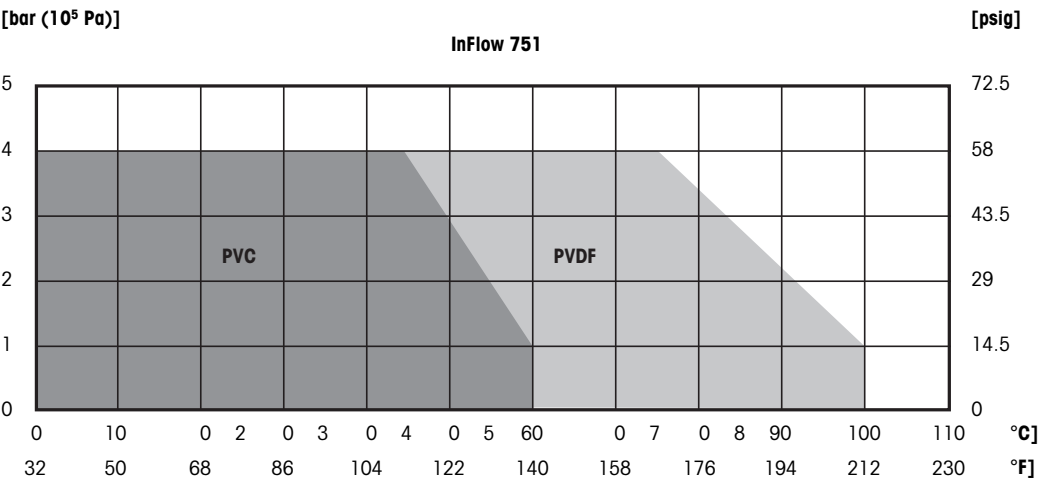

Product key InFlow 751

InFlow 751:	Material		
	PVDF:	PVDF polymer (polyvinylidenefluoride)	
	PVC:	PVC polymer (polyvinylchloride)	
	Pipe diameter		
	d32DN25:	Pipe diameter outside 32 mm (1.26"), nominal size 25 mm (0.98")	
	d50DN40:	Pipe diameter outside 50 mm (1.97"), nominal size 40 mm (1.58")	
	d63DN50:	Pipe diameter outside 63 mm (2.48"), nominal size 50 mm (1.97")	
	Interface electrode/sensor		
	Pg 13.5:	pH electrodes, DO/O ₂ and conductivity sensors with 12 mm (0.47") diameter and a length [a] of 120 mm (4.72")	
	NPT 1"	pH electrode InPro® 4500 VP or other sensors	
NPT ¾"	Conductivity sensors		
Examples: InFlow 751	PVDF	d32Dn25	Pg13.5
	PVC	d50DN40	NPT1"

Ordering information InFlow 751

Order No.

InFlow 751 – PVC version

InFlow 751 PVC d32DN25 Pg13.5	52 400 250
InFlow 751 PVC d32DN25 NPT ¾"	52 400 256
InFlow 751 PVC d50DN40 Pg13.5	52 400 251
InFlow 751 PVC d50DN40 NPT ¾"	52 400 257
InFlow 751 PVC d50DN40 NPT 1"	52 400 644
InFlow 751 PVC d63DN50 Pg13.5	52 400 252
InFlow 751 PVC d63DN50 NPT ¾"	52 400 258
InFlow 751 PVC d63DN50 NPT 1"	52 400 645

InFlow 751 – PVDF version

InFlow 751 PVDF d32DN25 Pg13.5	52 400 253
InFlow 751 PVDF d32DN25 NPT ¾"	52 400 259
InFlow 751 PVDF d50DN40 Pg13.5	52 400 254
InFlow 751 PVDF d50DN40 NPT ¾"	52 400 260
InFlow 751 PVDF d50DN40 NPT 1"	52 400 646
InFlow 751 PVDF d63DN50 Pg13.5	52 400 255
InFlow 751 PVDF d63DN50 NPT 1"	52 400 647

Spare parts**InFlow 751, PVC**

Spare parts set InFlow 751 PVC d=32	52 400 653
Spare parts set InFlow 751 PVC d=50	52 400 654

InFlow 751, PVDF

Spare parts set InFlow 751 PVDF d=63	52 400 658
--------------------------------------	------------

Further accessories on request at your local METTLER TOLEDO representative.

Together with housings and electrodes/sensors METTLER TOLEDO offers a wide range of transmitters and EasyClean automated cleaning and calibration systems. Highly automated and application-specific measuring systems to meet your needs can be provided. For further information see www.mt.com.

InFlow, InTrac, InFit and InPro are registered trademarks of the METTLER TOLEDO Group.

Viton and Kalrez are registered trademarks of DuPont Performance Elastomers LLC.

All other trademarks are the property of their respective holders.

METTLER TOLEDO Market Organizations

Sales and Service:

Australia

Mettler-Toledo Limited
220 Turner Street
Port Melbourne, VIC 3207
Australia
Phone +61 1300 659 761
e-mail info.mtaus@mt.com

Austria

Mettler-Toledo Ges.m.b.H.
Laxenburger Str. 252/2
AT-1230 Wien
Phone +43 1 607 4356
e-mail prozess@mt.com

Brazil

Mettler-Toledo Ind. e Com. Ltda.
Avenida Tamboré, 418
Tamboré
BR-06460-000 Barueri/SP
Phone +55 11 4166 7400
e-mail mtbr@mt.com

Canada

Mettler-Toledo Inc.
2915 Argentia Rd #6
CA-ON L5N 8G6 Mississauga
Phone +1 800 638 8537
e-mail ProlnsideSalesCA@mt.com

China

Mettler-Toledo International Trading
(Shanghai) Co. Ltd.
589 Gui Ping Road
Cao He Jing
CN-200233 Shanghai
Phone +86 21 64 85 04 35
e-mail ad@mt.com

Croatia

Mettler-Toledo d.o.o.
Mandlova 3
HR-10000 Zagreb
Phone +385 1 292 06 33
e-mail mt.zagreb@mt.com

Czech Republic

Mettler-Toledo s.r.o.
Trebohosticka 2283/2
CZ-100 00 Praha 10
Phone +420 2 72 123 150
e-mail sales.mtcz@mt.com

Denmark

Mettler-Toledo A/S
Naverland 8
DK-2600 Glostrup
Phone +45 43 27 08 00
e-mail info.mtdk@mt.com

France

Mettler-Toledo
Analyse Industrielle S.A.S.
30, Boulevard de Douaumont
FR-75017 Paris
Phone +33 1 47 37 06 00
e-mail mtpro-f@mt.com

Germany

Mettler-Toledo GmbH
Prozeßanalytik
Ockerweg 3
DE-35396 Gießen
Phone +49 641 507 444
e-mail prozess@mt.com

Great Britain

Mettler-Toledo LTD
64 Boston Road, Beaumont Leys
GB-Leicester LE4 1AW
Phone +44 116 235 7070
e-mail enquire.mtuk@mt.com

Hungary

Mettler-Toledo Kereskedelmi KFT
Teve u. 41
HU-1139 Budapest
Phone +36 1 288 40 40
e-mail mthu@axelero.hu

India

Mettler-Toledo India Private Limited
Amar Hill, Saki Vihar Road
Powai
IN-400 072 Mumbai
Phone +91 22 2857 0808
e-mail sales.mtin@mt.com

Indonesia

PT. Mettler-Toledo Indonesia
GRHA PERSADA 3rd Floor
Jl. KH. Noer Ali No.3A,
Kayuringin Jaya
Kalimalang, Bekasi 17144, ID
Phone +62 21 294 53919
e-mail mt-id.customersupport@mt.com

Italy

Mettler-Toledo S.p.A.
Via Vialba 42
IT-20026 Novate Milanese
Phone +39 02 333 321
e-mail customercare.italia@mt.com

Japan

Mettler-Toledo K.K.
Process Division
6F Ikenohata Nisshoku Bldg.
2-9-7, Ikenohata
Taito-ku
JP-110-0008 Tokyo
Phone +81 3 5815 5606
e-mail helpdesk.ing.jp@mt.com

Malaysia

Mettler-Toledo (M) Sdn Bhd
Bangunan Electroscon Holding, U 1-01
Lot 8 Jalan Astaka U8/84
Seksyen U8, Bukit Jelutong
MY-40150 Shah Alam Selangor
Phone +60 3 78 44 58 88
e-mail MT-MY.CustomerSupport@mt.com

Mexico

Mettler-Toledo S.A. de C.V.
Ejército Nacional #340
Polanco V Sección
C.P. 11560
MX-México D.F.
Phone +52 55 1946 0900
e-mail mt.mexico@mt.com

Norway

Mettler-Toledo AS
Ulvenveien 92B
NO-0581 Oslo Norway
Phone +47 22 30 44 90
e-mail info.mtn@mt.com

Poland

Mettler-Toledo (Poland) Sp.z.o.o.
ul. Poleczki 21
PL-02-822 Warszawa
Phone +48 22 545 06 80
e-mail polska@mt.com

Russia

Mettler-Toledo Vostok ZAO
Sretenskij Bulvar 6/1
Office 6
RU-101000 Moscow
Phone +7 495 621 56 66
e-mail inforus@mt.com

Singapore

Mettler-Toledo (S) Pte. Ltd.
Block 28
Ayer Rajah Crescent #05-01
SG-139959 Singapore
Phone +65 6890 00 11
e-mail mt.sg.customersupport@mt.com

Slovakia

Mettler-Toledo s.r.o.
Hattalova 12/A
SK-831 03 Bratislava
Phone +421 2 4444 12 20-2
e-mail predaj@mt.com

Slovenia

Mettler-Toledo d.o.o.
Pot heroja Trtnika 26
SI-1261 Ljubljana-Dobrunje
Phone +386 1 530 80 50
e-mail keith.racman@mt.com

South Korea

Mettler-Toledo (Korea) Ltd.
1 & 4F, Yeil Building 21
Yangjaecheon-ro 19-gil
Seocho-Gu
Seoul 06753 Korea
Phone +82 2 3498 3500
e-mail Sales_MTKR@mt.com

Spain

Mettler-Toledo S.A.E.
C/Miguel Hernández, 69-71
ES-08908 L'Hospitalet de Llobregat
(Barcelona)
Phone +34 902 32 00 23
e-mail mtemkt@mt.com

Sweden

Mettler-Toledo AB
Virkesvägen 10
Box 92161
SE-12008 Stockholm
Phone +46 8 702 50 00
e-mail sales.mts@mt.com

Switzerland

Mettler-Toledo (Schweiz) GmbH
Im Langacher, Postfach
CH-8606 Greifensee
Phone +41 44 944 47 60
e-mail ProSupport.ch@mt.com

Thailand

Mettler-Toledo (Thailand) Ltd.
272 Soi Soonvijai 4
Rama 9 Rd., Bangkok
Huay Kwang
TH-10320 Bangkok
Phone +66 2 723 03 00
e-mail MT-TH.CustomerSupport@mt.com

Turkey

Mettler-Toledo Türkiye
Haluk Türksay Sokak No: 6 Zemin ve 1.
Bodrum Kat 34662 Üsküdar-İstanbul, TR
Phone +90 216 400 20 20
e-mail sales.mttr@mt.com

USA

METTLER TOLEDO
Process Analytics
900 Middlesex Turnpike, Bld. 8
Billerica, MA 01821, USA
Phone +1 781 301 8800
Freephone +1 800 352 8763
e-mail mtprou@mt.com

Vietnam

Mettler-Toledo (Vietnam) LLC
29A Hoang Hoa Thám Street, Ward 6
Binh Thanh District
Ho Chi Minh City, Vietnam
Phone +84 8 35515924
e-mail MT-VN.CustomerSupport@mt.com



Management System
certified according to
ISO 9001 / ISO 14001



Subject to technical changes.
© Mettler-Toledo GmbH 04/2017
Printed in Switzerland. 52 403 713

Mettler-Toledo GmbH, Process Analytics
Im Hackacker 15, CH- 8902 Urdorf
Phone +41 44 729 62 11, Fax +41 44 729 66 36

www.mt.com/pro